

VIBRATING FEEDERS

VIBRATING SCREENS – EVA

VIBRATING FEEDERS FOR SINGLE MACHINE

**TECHNICAL FEATURES**

- Box made of quality carbon steel
- Wear-resistant plates welded onto the sliding-surface of the feeder
- Electric vibrators
- Elastic spring-supports or rubber puffers
- Possibility of a positive inclination up to 10° for fine and/or very wet materials, i.e. wood-saw-dust, fine chips, etc.

BENEFITS

- High performance
- Excellent feeding and fluidizing of any type of raw wood
- Minimized energy consumption
- Minimized labour cost
- Low maintenance cost.

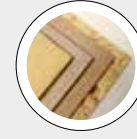
BEST IN CLASS FOR:

WOOD BASED PANELS:
MDF/HDF
PB/SPB
OSB/LSB/FOSB
INSULATION BOARDS

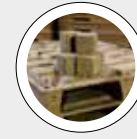

PRESSED WOOD PACKAGING:
PALLET BLOCKS



PELLETS & ENERGY:
WOOD PELLETS AND
BLACK PELLETS

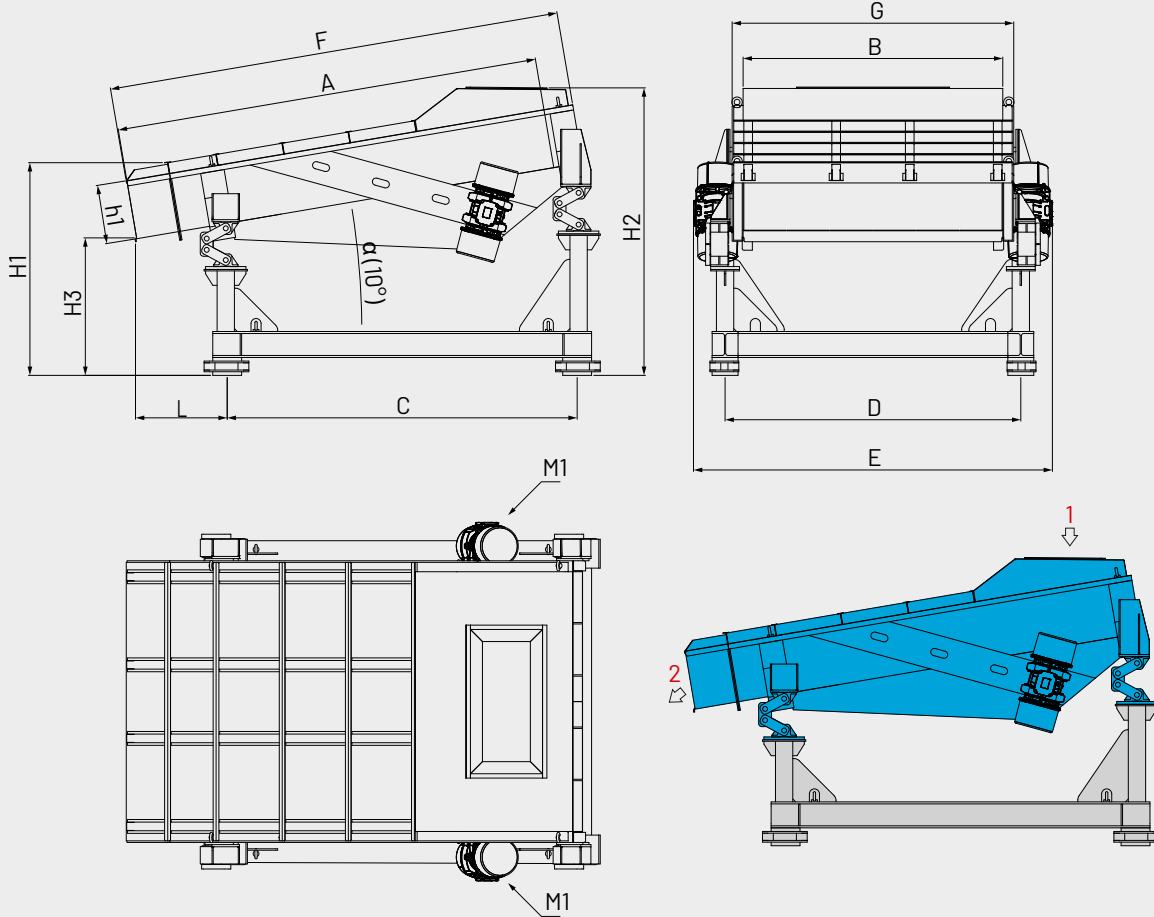

1 = FEEDING
2 = DISCHARGE

M1 = MAIN MOTOR

MODEL	OVERALL DIMENSIONS mm											
	A	B	C	D	E	F	G	h1	H1	H2	H3	L
EVA.60/18	1800	600	1400	876	1150	1960	736	200	960	1300	763	492
EVA.90/20	2055	900	1400	900	1430	2220	1000	200	912	1297	715	744
EVA.90/25	2500	900	2200	1190	1430	2585	1052	256	986	1496	655	270
EVA.120/25	2500	1200	1700	1670	2000	2675	1336	300	936	1400	641	886
EVA.140/25	2500	1400	1700	1680	1992	2660	1540	300	938	1400	643	886
EVA.150/30	3000	1500	2445	1780	2010	3135	1652	306	1140	1400	700	601
EVA.180/30	3000	1800	2420	2090	2325	3135	1952	386	1140	1975	953	620
EVA.200/30	3000	2000	2390	2370	2565	3160	2230	386	1170	1740	787	720
EVA.300/30	3000	3000	2472	3200	3750	3135	3152	400	1475	1975	935	510

MODEL	CAPACITY BULK m ³ /h	INSTALLED POWER kW	WEIGHT APPROX. kg
EVA.60/18	According to type of material	2 x 0,68	340
EVA.90/20		2 x 0,90	600
EVA.90/25		2 x 1,00	720
EVA.120/25		2 x 1,50	900
EVA.140/25		2 x 1,50	1820
EVA.150/30		2 x 1,96	2000
EVA.180/30		2 x 1,96	2560
EVA.200/30		2 x 3,20	3300
EVA.300/30		2 x 3,20	4900