



• PB • MDF • PALLET BLOCK • WASTE



IMAL  
PAL  
GROUP

## OPTICAL SORTER

### CYCLOPS X-RAY

PATENTED

#### TECHNICAL FEATURES

- High speed belt for monolayer and multilayer particles transfer
- High efficiency and constant performance of x-ray camera
- Integrated sw control system
- Selecting unit with compressed air
- Discharge hopper with selecting flap
- Heavy construction for continuous operation.

#### BENEFITS

- Possibility of feeding any type of raw wood
- Removal of many kind of pollutants, plastic, metals, inerts and heavy material
- Very high efficiency
- Compact layout
- Low maintenance
- Easy control and adjustment.

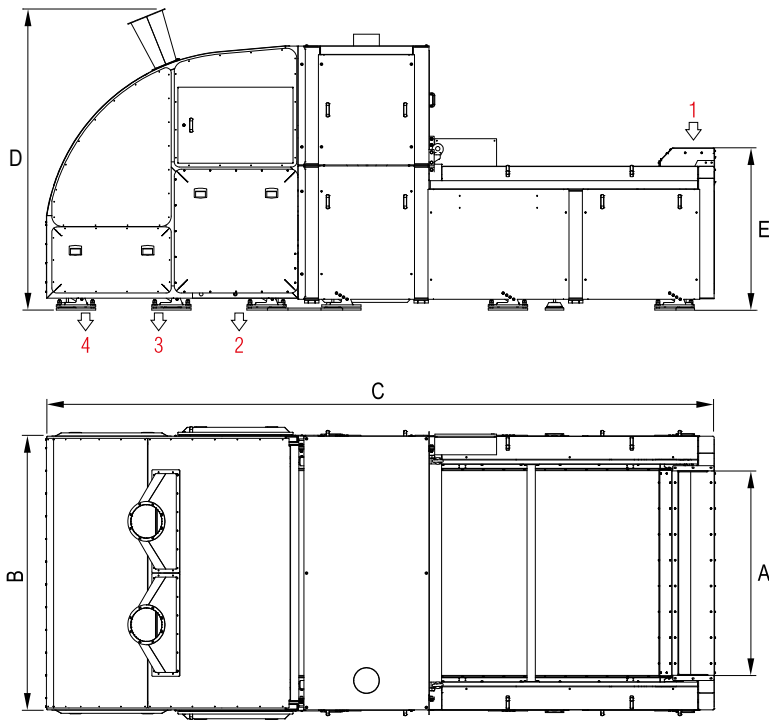

1 = INLET MATERIAL  
2 = POLLUTANTS AND METALS

3 = HEAVY MATERIAL  
4 = CLEANED MATERIAL

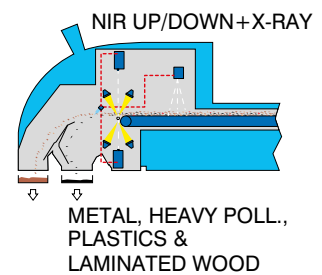
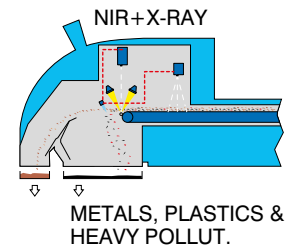
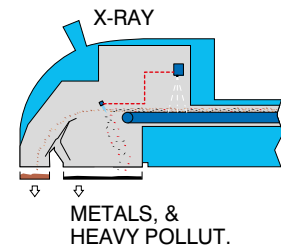

M1 = BELT ROTATION  
M2 = FAN

MODEL	OVERALL DIMENSIONS mm				
	A	B	C	D	E
<b>XCS.1200</b>	1200	1940	6460	3000	1910
<b>XCS.1.1200</b>	1200	1940	6460	3000	1910
<b>XCS.2000</b>	2000	2730	6460	3000	1910
<b>XCS.2.2000</b>	2000	2730	6460	3000	1910

MODEL	CAPACITY		INSTALLED POWER kW		EXHAUST AIR FLOW m <sup>3</sup> /h
	MICRO CHIPS 10-30 mm	MACRO CHIPS >30 mm	M1	M2	
<b>XCS.1200</b>	130 m <sup>3</sup> /h	130 m <sup>3</sup> /h	3	-	3000
<b>XCS.1.1200</b>	35 m <sup>3</sup> /h	60 m <sup>3</sup> /h	3	1,10	3000
<b>XCS.2000</b>	200 m <sup>3</sup> /h	200 m <sup>3</sup> /h	4	-	4000
<b>XCS.2.2000</b>	70 m <sup>3</sup> /h	120 m <sup>3</sup> /h	4	1,50	4000